

RECOMMENDED HOLES LAYOUT

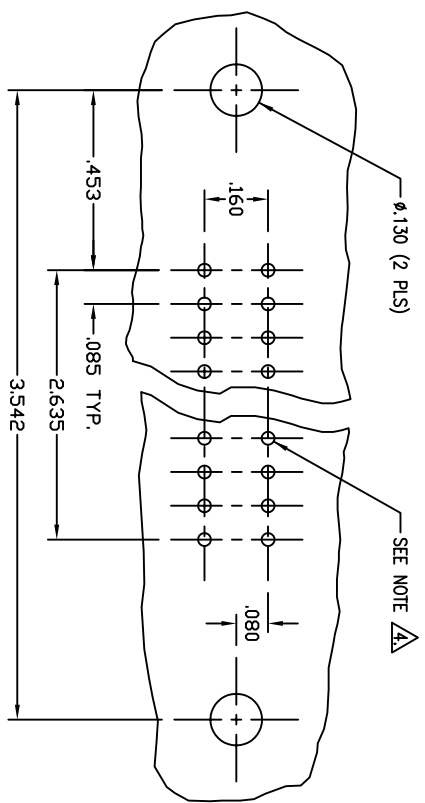

REVISIONS			
REV	DESCRIPTION	DATE	APPROVED
A	INITIAL RELEASE (ESR 0881)	04-03-97	JWM
B	SEE ECN 90414	05-22-97	JWM

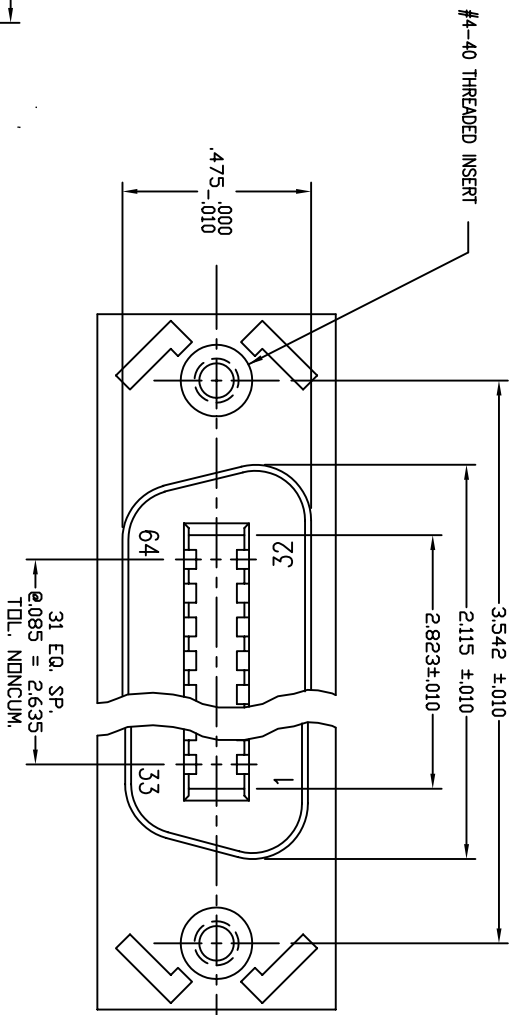

NOTES:

- MATERIAL:**
  - \* INSULATOR - 30% GLASS REINFORCED THERMOPLASTIC POLYESTER (PBT) VALOX 420 SED OR EQUIVALENT UL 94V-0 RATED, COLOR - BLACK.
  - \* CONTACT - PHOSPHOR BRONZE CDA 510.
  - \* CONTACT PLATING - NICKEL PLATE .000050 MIN. THICK ALL OVER, GOLD PLATE .000030 MIN. THICK ON CONTACT AREA, .000100 MIN. Snpb OVER TAIL AND COMPLIANT AREA.
- ELECTRICAL CHARACTERISTICS:**
  - \* CONTACT RESISTANCE - 10 MILLIOHMS MAX.
  - \* INSULATION RESISTANCE - 5000 MEGOHMS.
  - \* WITHSTANDING VOLTAGE - 1000 VRMS
  - \* CURRENT RATING - 3 AMPERS MAX. PER CONTACT PAIR.
- MECHANICAL CHARACTERISTICS:**
  - \* OPERATING TEMPERATURE - FROM -55°C TO +105°C.
  - \* COMPLIANT SECTION INSERTION FORCE - 30 LB. MAX. PER CONTACT.
  - \* COMPLIANT SECTION WITHDRAWAL FORCE - 10 LB. MIN. PER CONTACT.

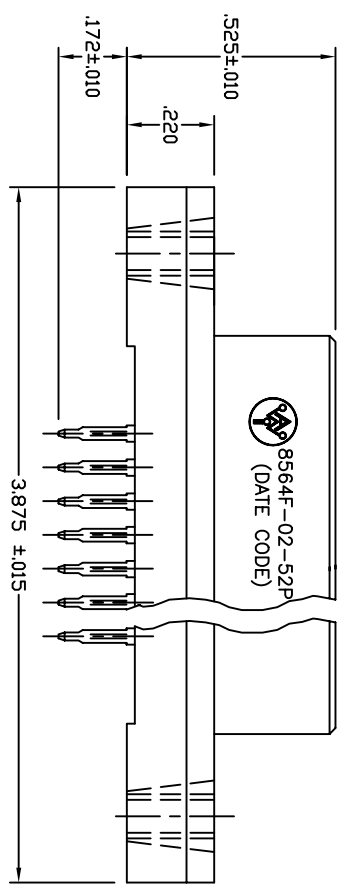
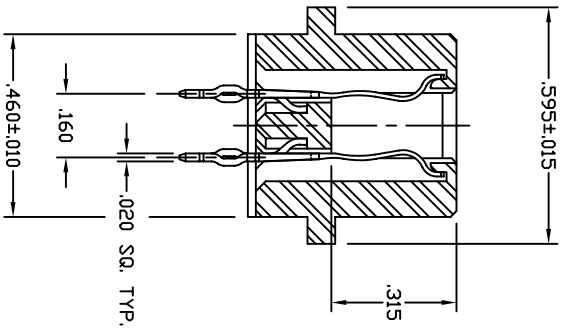

CUSTOMER DRAWING

4. PRINTED CIRCUIT BOARD HOLE INFORMATION:

- \* BEFORE THRU-HOLE PLATING - .037---.039 DIA.
- \* COPPER THRU-HOLE PLATING THICKNESS - .001---.002.
- \* TIN-LEAD THRU-HOLE PLATING THICKNESS - .0003---.0012 PORE FREE.
- \* FINISHED HOLE DIMENSION - .030---.035 DIA.

5. FLAT ROCK ASSEMBLE TO BACKPANEL, NO SPECIAL TOOLING REQUIRED.

6. MARKING AS SHOWN.

APPROVED	
NAME	DATE
JWM	04-97
JMP	04-97
WBK	04-97
JWM	04-97

THE INFORMATION, DATA AND/OR SPECIFICATIONS CONTAINED ON THIS DRAWING ARE PROPRIETARY TO A.W. INDUSTRIES AND MAY NOT BE COPIED, REPRODUCED OR DISCLOSED IN ANY MANNER WITHOUT THE WRITTEN PERMISSION OF A.W. INDUSTRIES.

ALL DIMENSIONS ARE IN INCHES.

TOLERANCES:  
DECIMAL .XX ±.015  
.XXX ±.005  
ANGLE ±1/2'

**A.W. Industries, Incorporated**  
6788 N.W. 17th AVENUE  
Fort Lauderdale, FL 33309

**PRESS FIT CONNECTOR  
64 PIN RECEPTACLE**

8564F-02-52P (DATE CODE)

31 EQ. SP. @.085 = 2.635 TDL. MINIMUM.

SIZE C SCALE NONE ACAD FILE NO. 03-0495-0B SHEET 1 OF 1