

REVISIONS			
REV	DESCRIPTION	DATE	APPROVED
A	PRELIMINARY	01-30-97	JWM

**NOTES:**

- MATERIALS AND FINISH:**  
INSULATOR- GLASS FILLED THERMO-PLASTIC  
POLYESTER, 94V-0 RATED, BLACK.  
CONTACTS- CDA 725  
CONTACT PLATING- .000010 Au OVER .000050 Ni ON  
CONTACT POINT, TAIL .000100 MATTE FINISH 60/40 SnPb.

- ELECTRICAL CHARACTERISTICS:**  
CONTACT RESISTANCE- 10 MILLIOHMS  
DIELECTRIC WITHSTANDING VOLTAGE- 1500 VAC  
INSULATION RESISTANCE- 5000 MEGOHMS.  
CONTACT CURRENT RATING- 3 AMPS AT 30°C.

- MECHANICAL CHARACTERISTICS:**  
OPERATING TEMPERATURE- -55 TO +125°C.  
DURABILITY- PER BELLCORE TR-NWT-000078.

MARKING AS SHOWN.

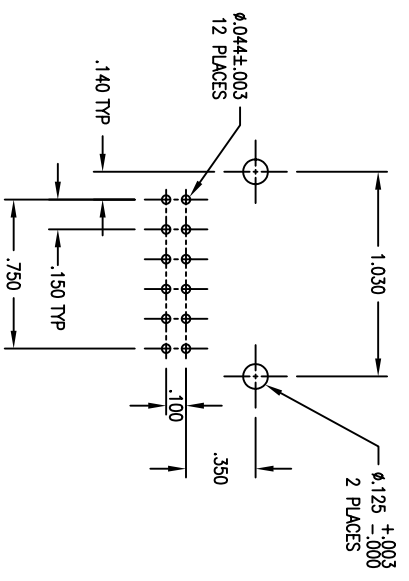

RECOMMENDED HOLE SIZES  
AND LOCATIONS

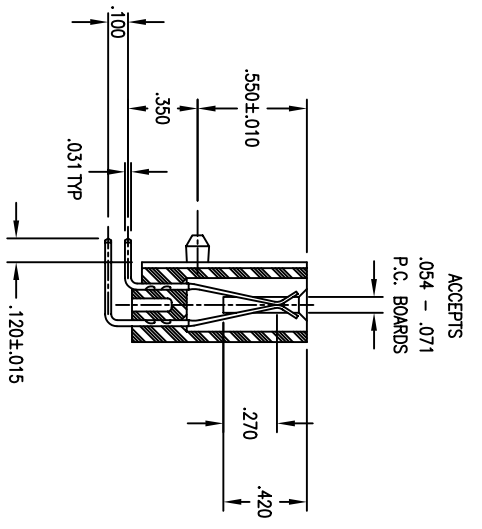

ACCEPTS  
.054 - .071  
P.C. BOARDS

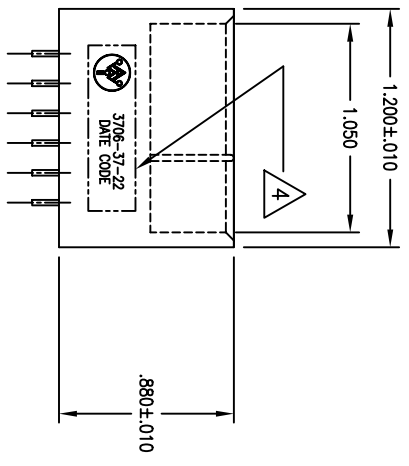
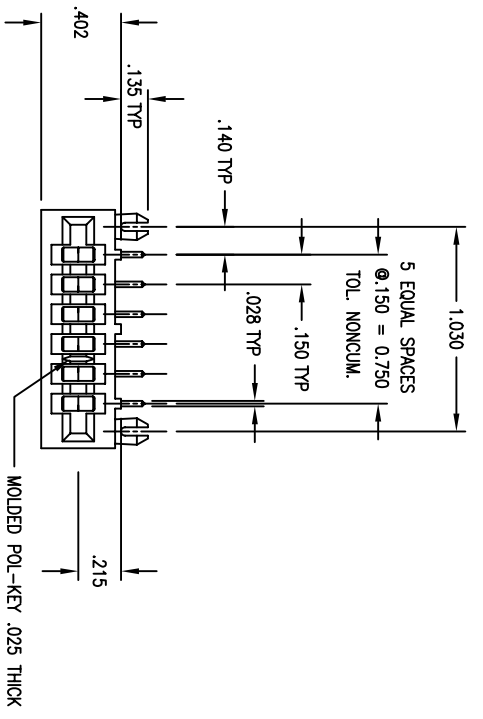

**CUSTOMER DRAWING**

APPROVED	
NAME	DATE
DESIGN JWM	01-97
CHECKED JMP	01-97
QUALITY WBK	01-97
APPROVED JWM	01-97

ALL DIMENSIONS ARE IN INCHES.

THE INFORMATION, DATA AND/OR SERVICES CONTAINED ON THIS DRAWING ARE PROPRIETARY TO A.W. INDUSTRIES AND MAY NOT BE COPIED, REPRODUCED OR DISCLOSED IN ANY MANNER WITHOUT THE WRITTEN PERMISSION OF A.W. INDUSTRIES.

TOLERANCES:  
DECIMAL .XX ±.015  
.XXX ±.005  
ANGLE ±1/2°

**A.W. Industries, Incorporated**  
6788 N.W. 17th AVENUE  
Fort Lauderdale, FL 33309

3706-37-22

SCALE NONE ACO FILE NO. 03-0460-0A SHEET 1 OF 1