

REV		DESCRIPTION	DATE	APPROVED
A	INITIAL RELEASE (ESR 0139)		03-31-95	JWM

REVISIONS

NOTES:

- MATERIALS AND FINISH:**  
INSULATOR - GLASS FILLED THERMO-PLASTIC POLYESTER, 94W-0 RATED, BLACK.  
CONTACTS - COPPER ALLOY (BeCu)  
CONTACT PLATING - .000050 IN ON ENTIRE CONTACTN  
.000050 Au ON ALL ENGAGEMENT AREAS.
- ELECTRICAL CHARACTERISTICS:**  
CONTACT RESISTANCE - 20 MILLIOHMS MAX.  
CONTACT CURRENT RATING - 0.5 AMPS AT 30°C.  
DIELECTRIC WITHSTANDING VOLTAGE - 1000 VAC.  
INSULATION RESISTANCE - 5000 MEGOHMS.
- MECHANICAL CHARACTERISTICS:**  
OPERATING TEMPERATURE - -55 TO +125°C.  
DURABILITY - PER BELLCORE TR-NWT-000078.
- MARKING AS SHOWN, WHITE INK.**

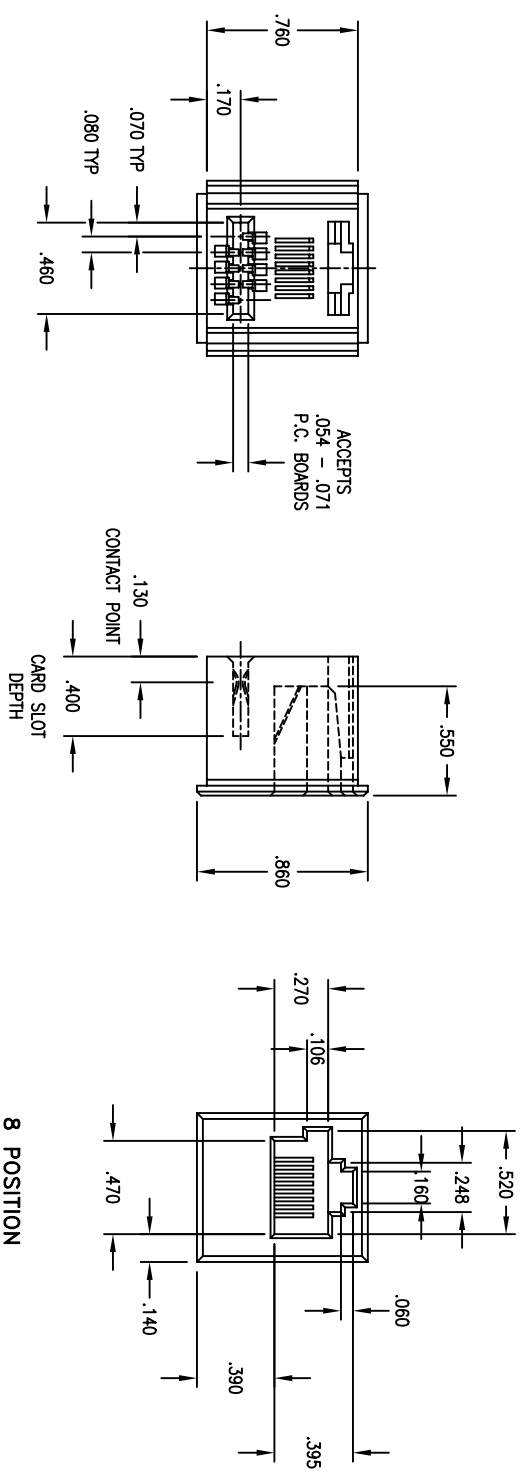

8 POSITION  
KEYED  
CONNECTOR  
(08KH)

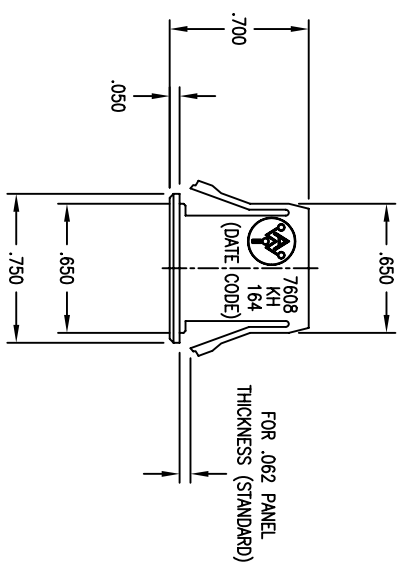

CUSTOMER DRAWING

APPROVED		DATE
NAME	JWM	03-95
CHECKED	YL	03-95
QUALITY	WBK	03-95
APPROVED	JWM	03-95

ALL DIMENSIONS ARE IN INCHES.  
TOLERANCES:  
DECIMAL .XX ±.015  
.XXX ±.005  
ANGLE ±1/2°

THE INFORMATION, DATA AND/OR SERVICES CONTAINED ON THIS DRAWING ARE PROPRIETARY TO A.W. INDUSTRIES AND MAY NOT BE COPIED, REPRODUCED OR DISCLOSED IN ANY MANNER WITHOUT THE WRITTEN PERMISSION OF A.W. INDUSTRIES.

**A.W. Industries, Incorporated**  
6788 N.W. 17th AVENUE  
Fort Lauderdale, FL 33309

MODULAR JACK-CARD EDGE CONNECTOR  
8 POSITION KEYED

SIZE C  
SCALE NONE  
DWG. NO. 7608KH-164  
SHEET 1 OF 1